

# SUSPENSION

## CHARIOT HENDRICKSON Type HS

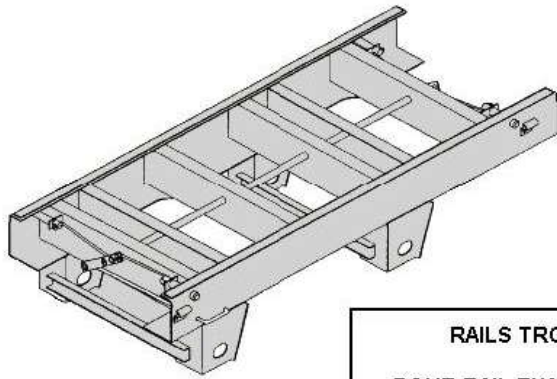

**STYLE HENDRICKSON**

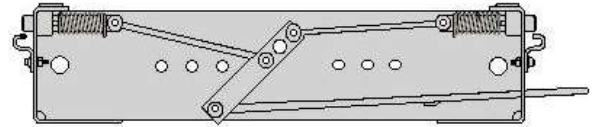

**STYLE BINKLEY**

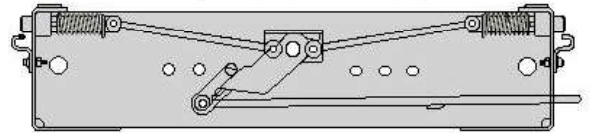

**RAILS TROUÉS 6" CC**

POUR RAIL EXACT FOURNIR LE # DE SÉRIE DU FABRICANT DE LA REMORQUE OU SI POSSIBLE LE # DE SÉRIE DE LA SUSPENSION

**CLIP 1-1/2"**

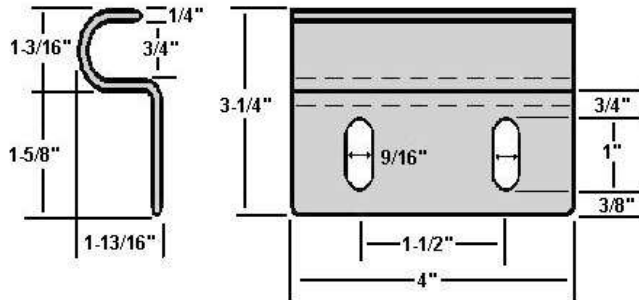

**HT-S14108**

**CLIP 2"**

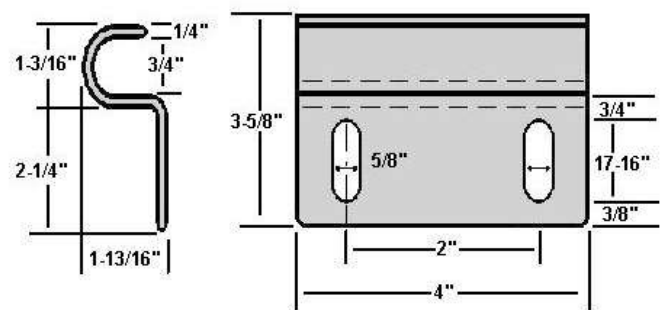

**HT-S22366**

**TIGE DE VERROUILLAGE**

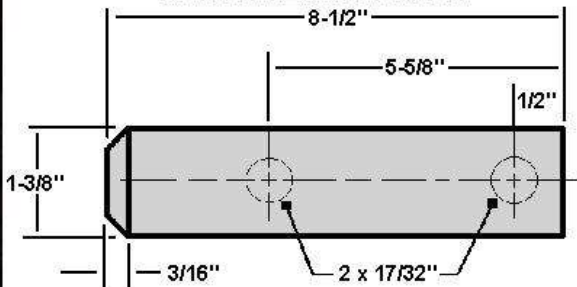

**HT-S14104**

**RESSORT DE TIGE DE VERROUILLAGE**



**HT-S14102**

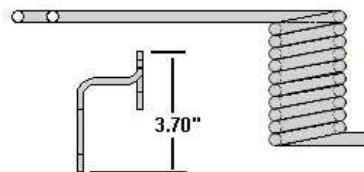
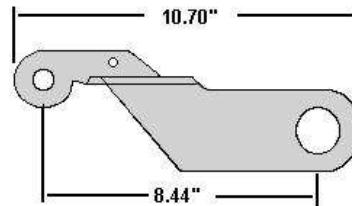

**SLOR1277-1**

**SL0019**

**BARRE DE POSITIONNEMENT**



**BARRE DE POSITIONNEMENT**

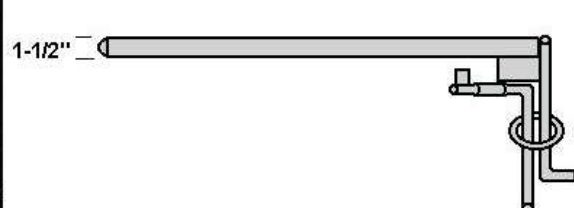

HT-S14131-2 cadre 42"

HT-S14131-8 cadre 48" 53-1/4"

HT-S14131-8 cadre 48" 53-1/4"

# SUSPENSION

## CHARIOT HENDRICKSON Type HS - HUTCHENS

STYLE HUTCHENS

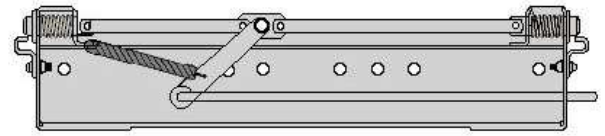
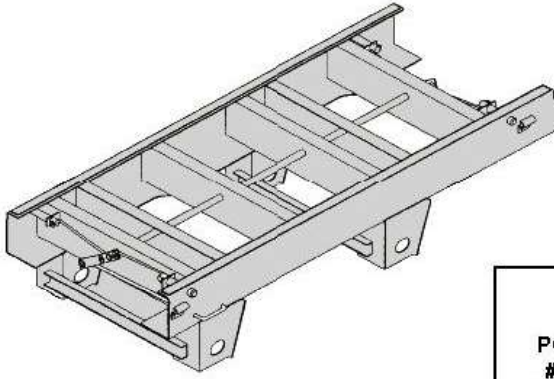

RAILS TROUÉS 6" CC

POUR RAIL EXACT FOURNIR LE  
# DE SÉRIE DU FABRICANT DE  
LA REMORQUE OU SI POSSIBLE  
LE # DE SÉRIE DE LA SUSPENSION

GUIDE DE CHARIOT

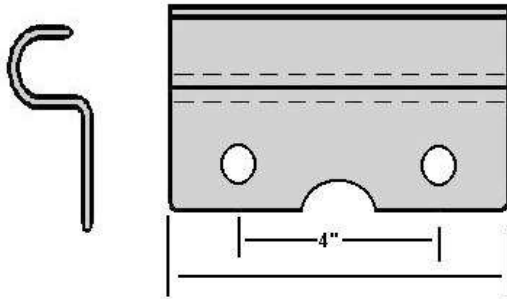

HU-12715-01

RESSORT DE RAPPEL



HU-8018-02

RESSORT DE TIGE  
DE VERROUILLAGE



HU-12779-01

BARRE DE POSITIONNEMENT

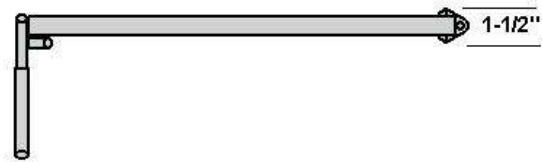

HT-S21477-4

BARRE DE POSITIONNEMENT

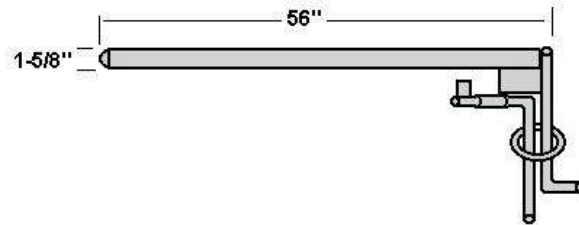

TIGE DE VERROUILLAGE

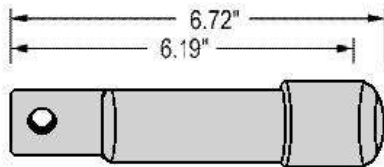

HU-12716-01

4001-0-438

MANAC

# SUSPENSION

## CHARIOT HENDRICKSON Type K-2

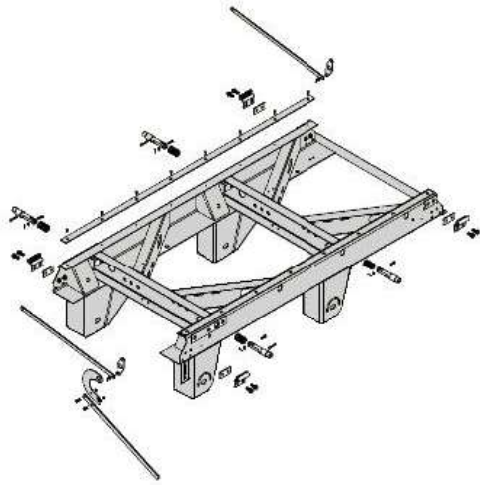

**STYLE BINKLEY**  
RAIL TROUÉ 6" C.C.

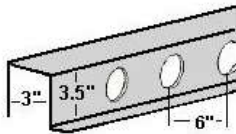

BK-SL0853-XX	dia. trous 1-1/2"
BK-SL0A1203-XX	dia. trous 1-1/2"

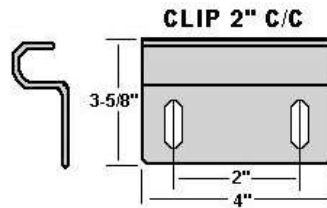

**CLIP 2" C/C**  
HT-S22366

### ACTION MANUELLE

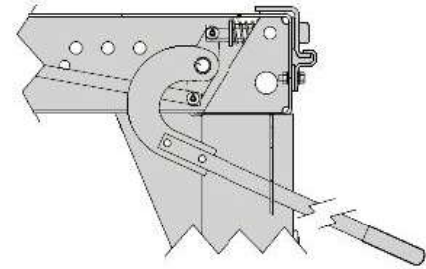

**STYLE HUTCH**  
RAIL TROUÉ 4" C.C.

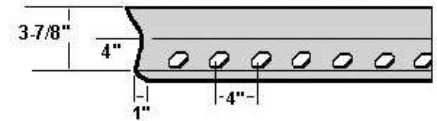

HU-12713-XX	dia. trous 1-13/16"
HU-16816-XX	dia. trous 1-13/16"

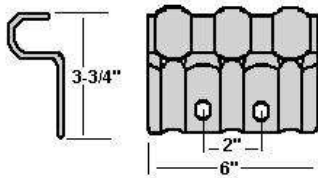

**CLIP 2" C/C**  
HT-S24460

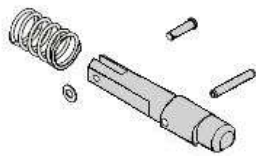

HT-B28930	Ressort	
HT-S28290	Axe	

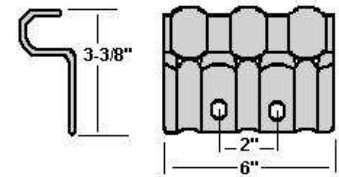

**CLIP 2" C/C**  
HT-S24459

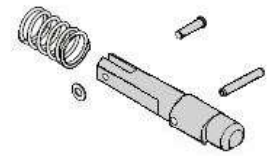

HT-B28930	Ressort	
HT-S28289	Axe	

### BARRE DE POSITIONNEMENT

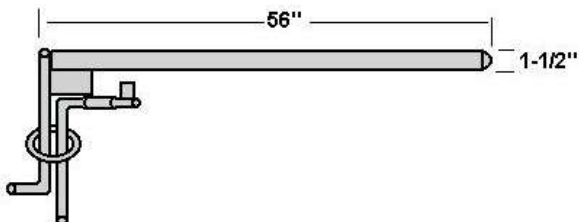
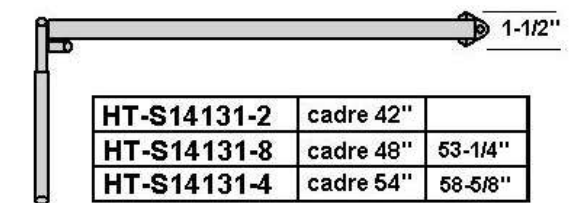

4001-0-437 cadre 48"

### BARRE DE POSITIONNEMENT

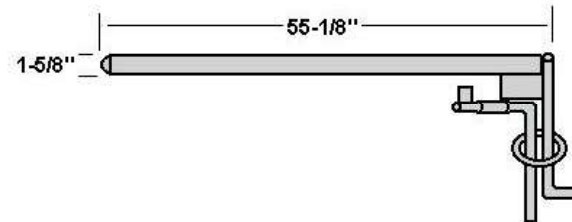
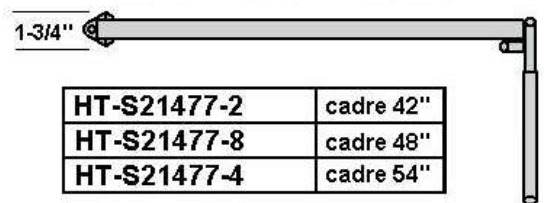

4001-0-438 cadre 48"